

05.03.10



SAFeway STORE NUMBER 3134
 PORTLAND, OREGON
 19110 N. HAYTHORNE BLVD. & SE 29TH AVENUE
 PORTLAND, OREGON

NO.	DATE	BY	REVISION
1	05/03/10	CDQ1	ISSUED FOR PERMIT
2			
3			
4			
5			
6			
7			
8			
9			
10			

DATE	05/03/10
PROJECT	SAFeway STORE #3134
CLIENT	SAFeway
SCALE	AS SHOWN
DESIGNER	CDQ1
CHECKER	
DATE	
PROJECT	
CLIENT	
SCALE	
DESIGNER	
CHECKER	
DATE	

SITE DATA	
STORE	56,718 G.S.F.
FUEL CENTER	
LEASESPACE	56,718 G.S.F.
TOTAL BUILDING AREA	N/A
SITE AREA	171.66 FE
SITE COVERAGE	0.0%
(0/70=0)	
PARKING RATIOS	
2.40 STALLS PER 1,000 SF	
[134/ 56,718 = 2.40]	
2.40 STALLS (CONVENIENCE) PER 1,000 SF	
[134/ 56,718 = 2.40]	
PARKING DATA	
STALLS PROVIDED:	128
STANDARD STALLS PROVIDED:	0
COMPACT STALLS PROVIDED:	0
ACCESSIBLE STALLS PROVIDED:	134
TOTAL STALLS PROVIDED:	134
CONVENIENCE PARKING:	
WITHIN 200 FEET OF DOORS	134

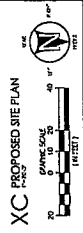

XC PROPOSED SITE PLAN

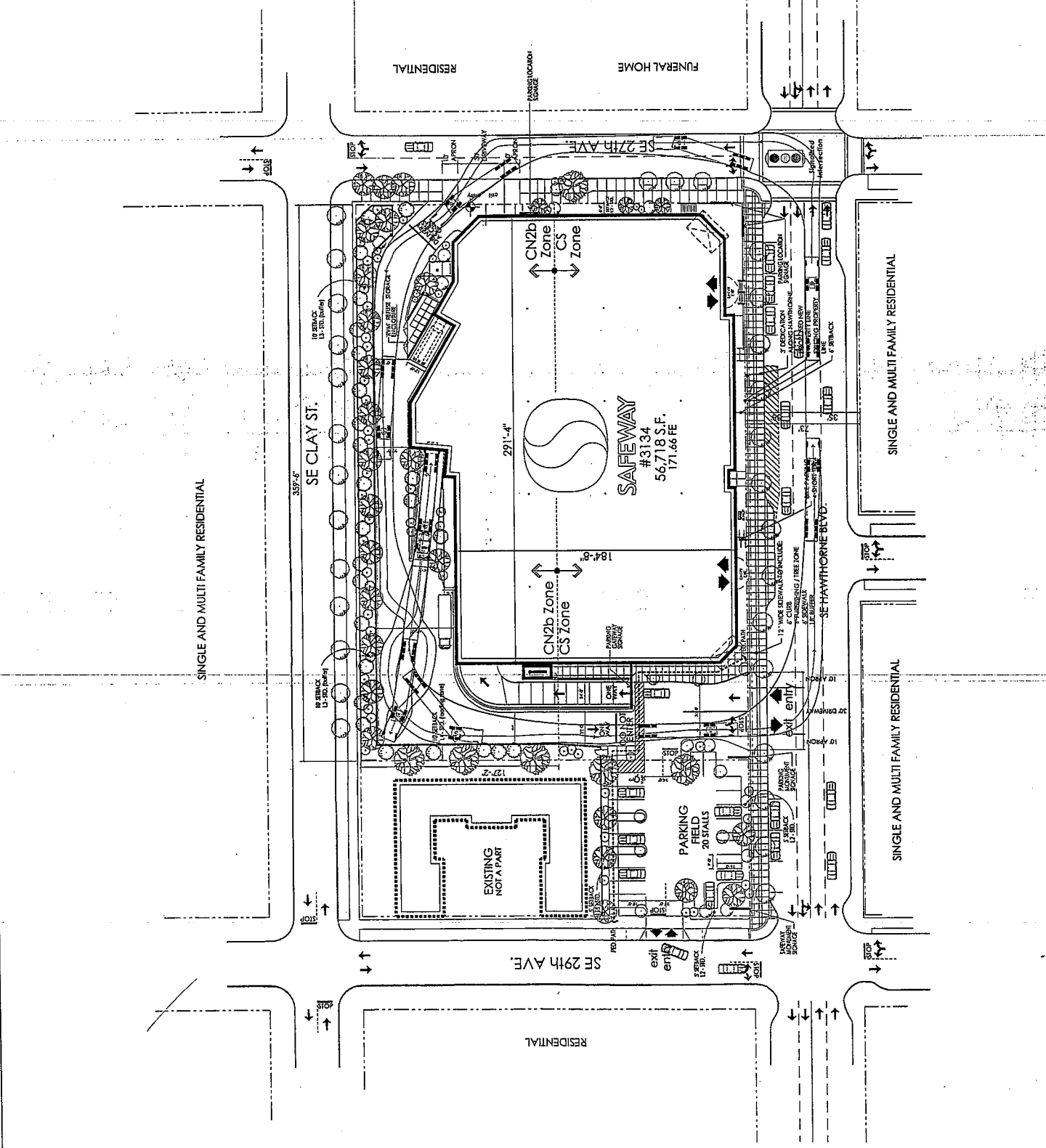

05.03.10

SAFeway

SAFeway STORE NUMBER 3134
PORTLAND, OREGON
ACORN BLVD. # 3134-000001
HAWTHORNE BLVD. & SE 27th AVENUE
PORTLAND, OREGON

DATE	05/03/10
DESIGNED BY	...
CHECKED BY	...
SCALE	AS SHOWN
PROJECT NO.	...
DRAWING NO.	...

PROPOSED GARAGE PLAN
XC-102

SE CLAY ST.

SE HAWTHORNE BLVD.

